

Your Specifications for Handy-navi2-Bolt

Date: / /

Thank you for your inquiry about **Handy-navi2-Bolt**. Please fill in and send us back.

1) Trading Company			
Company name			
Department		Position	
Name			

2) Manufacturer			
Company name			
Department		Position	
Name			

- 3) Power supply frequency — ☐ 50Hz ☐ 60Hz
- 4) Your spot welding machine — Maker ()
- 5) Squeeze time (cycle)
- 6) Bolt feeding method — ☐ Feeder ☐ Manual feed
- 7) Bolt feeder — Maker ()
- 8) Water hose joint — L-shaped hose connector
- 9) Air piping — ☐ from the feeder ☐ from the primary side
- 10) Specification



- Set the start-up self-hold on the welding machine to activate when the current starts to flow.
- Please provide us 5 pcs. each of bolt samples.

Bolt size	Below the head	Hole diameter of work	Board thickness	Welding current	Weld flow time
M	mm	φ	t	A	cycle
M	mm	φ	t	A	cycle
M	mm	φ	t	A	cycle
M	mm	φ	t	A	cycle
M	mm	φ	t	A	cycle

11) Dimensions of Holder and Horn

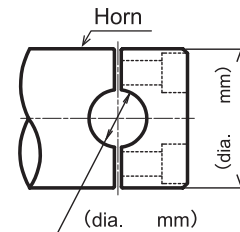
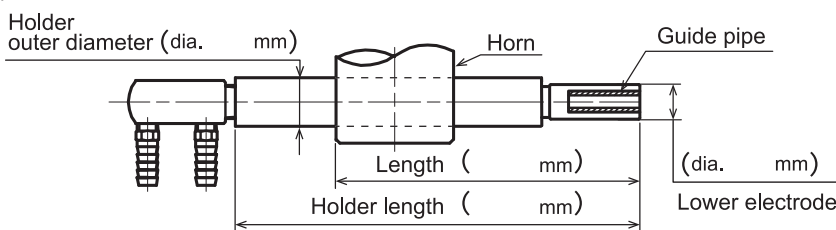

12) The shape of metal connector and number of pins of the foot-operated switch or the connector between nut feeder and welding machine in use.

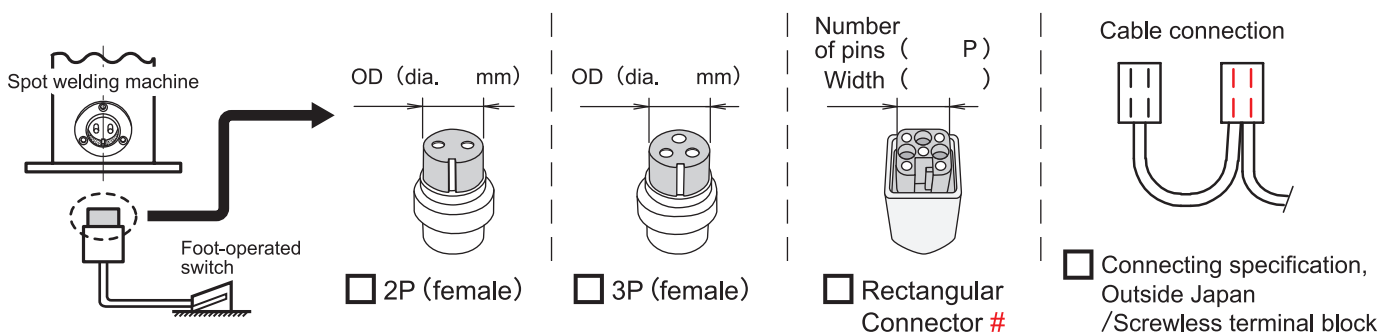

If you select a rectangular connector, please send us a photo and electrical drawing to confirm start signal.

Example

Your Specifications for Handy-navi2-Bolt

Date: / /

Thank you for your inquiry about **Handy-navi2-Bolt**. Please fill in and send us back.

1) Trading Company				2) Manufacturer			
Company name	Trading Company name			Company name	Manufacturer Company name		
Department	sales department	Position	General Manager	Department	sales department	Position	General Manager
Name	John Doe			Name	Jane Doe		

- 3) Power supply frequency — ☒ 50Hz ☐ 60Hz
 4) Your spot welding machine — Maker (**Maker name**)
 5) Squeeze time — (**20** cycle)
 6) Bolt feeding method — ☒ Feeder ☐ Manual feed
 7) Bolt feeder — Maker (**Maker name**)
 8) Water hose joint — L-shaped hose connector
 9) Air piping — ☒ from the feeder ☐ from the primary side
 10) Specification

Bolt size	Below the head	Hole diameter of work	Board thickness	Welding current	Weld flow time
M 6	15 mm	ϕ 6.2	t 1.6	10,000 A	6 cycle
M 8	20 mm	ϕ 8.2	t 1.2	11,000 A	8 cycle
M	mm	ϕ	t	A	cycle
M	mm	ϕ	t	A	cycle
M	mm	ϕ	t	A	cycle

11) Dimensions of Holder and Horn

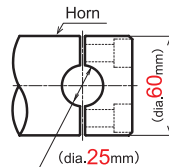
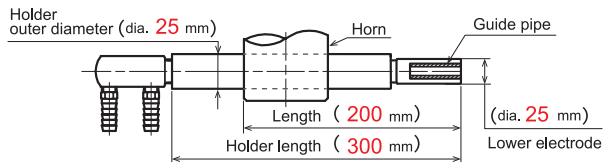

12) The shape of metal connector and number of pins of the foot-operated switch or the connector between nut feeder and welding machine in use.

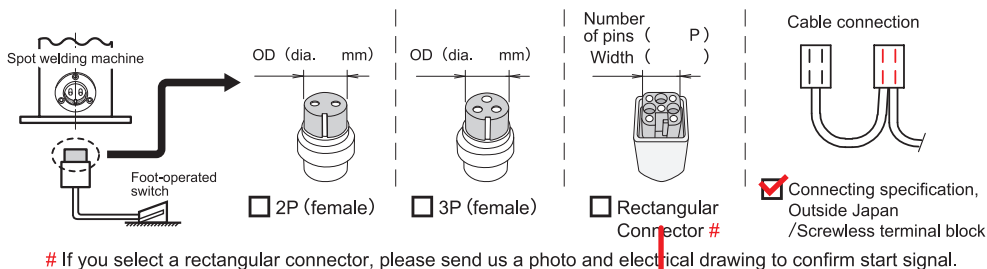

SMK

E-mail : smk_overseas@e-smk.co.jp

Write your full name.

When step on the foot-operated switch for a moment,

1. Pressurization is released immediately.
→ Self-hold works with starting of energization.
2. Pressurization is not released.
→ Self-hold works since the squeeze time.

We will manufacture the slide unit to fit sample bolt you supplied to us.

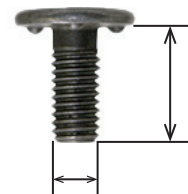

Below the head

Bolt size

Board thickness t Hole ϕ

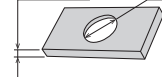

* If you do not have enough space to fill out the form, please send us multiple copies of the production specifications.

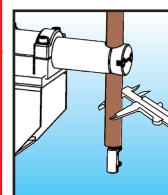

Holder outer diameter

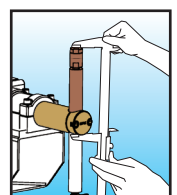

Length

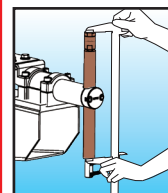

Holder length

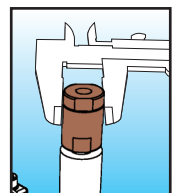

Lower electrode

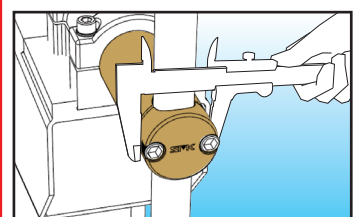

Horn outer diameter



Check the bottom of the welding machine. If you use a nut feeder, check the connector between nut feeder and welding machine.

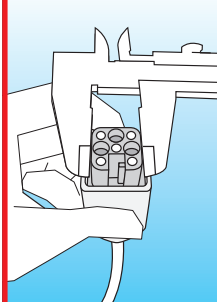

Please take a picture so that we can see the size of a connector and the number of pins.